

## SPECIFICATIONS:

CONTACT RATING: Refer to "Contact material Options" for more info.

CONTACT RESISTANCE: 10mΩ max.

ELECTRICAL LIFE: 10,000 cycles at full load.

MECHANICAL LIFE: 20,000 cycles.

INSULATION RESISTANCE: 1,000MΩ min. @ 500VDC.

OPERATION TEMPERATURE: -30°C to +85°C.

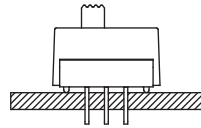
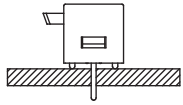
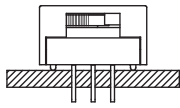

## MATERIALS:

CASE: PBT.

HOUSING: POM.

SLIDE HANDLE: PBT.

TERMINAL SEAL: Epoxy.

Specifications and Dimensions subject to change

If your preferred product configuration is not shown, please contact our sales representative for custom design.

## HOW TO ORDER SYSTEM

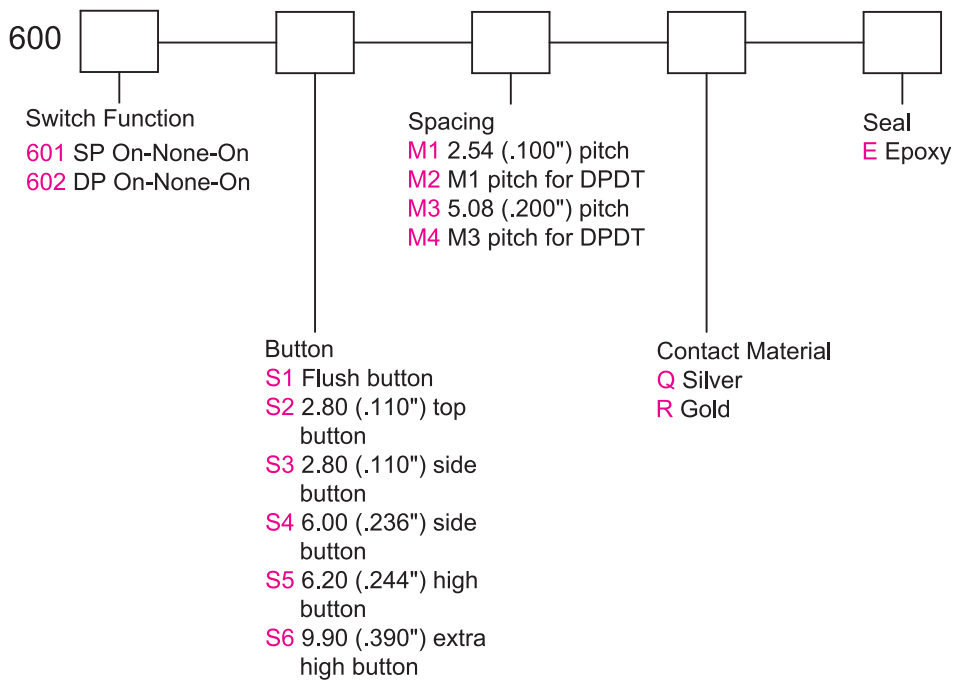

# Series 600

# Miniature Slide Switches For P.C.Board

SPDT

Model No.	Switching Position		
	601	ON	NONE
	2-1	OPEN	2-3



DPDT

Model No.	Switching Position		
	602	ON	NONE
	2-1,5-4	OPEN	2-3,5-6

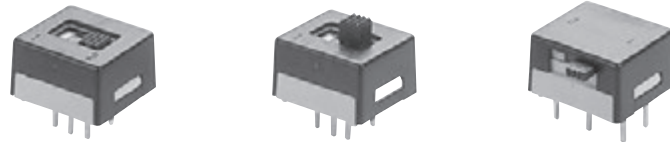

## BUTTON OPTIONS

### S1 FLUSH BUTTON

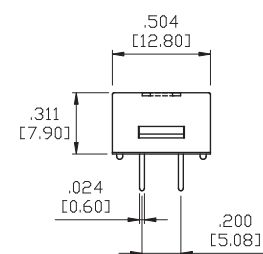
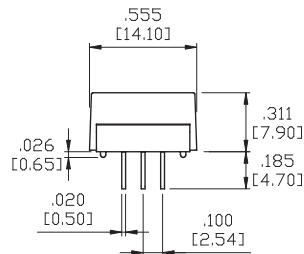
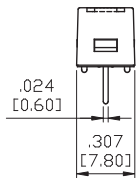

### S2 TOP BUTTON

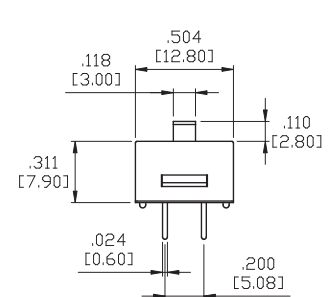
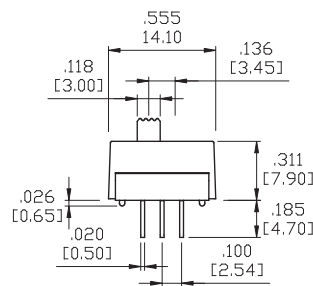
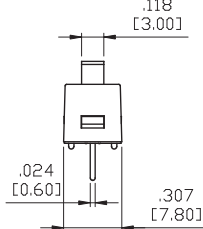

### S3 SIDE BUTTON

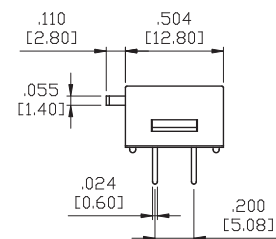
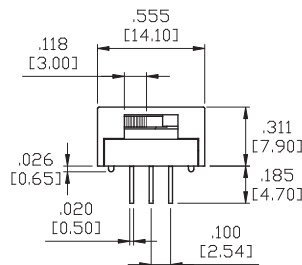
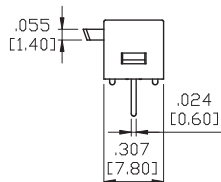

### S4 SIDE BUTTON (DPDT ONLY)

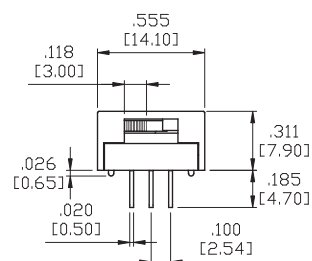
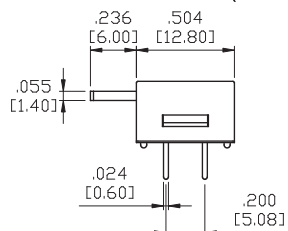

Toggle

Rocker

Slide

Pushbutton

AV

Rotary

Tact

Touch Key

Miscellaneous

BUTTON OPTIONS

S5 HIGH BUTTON

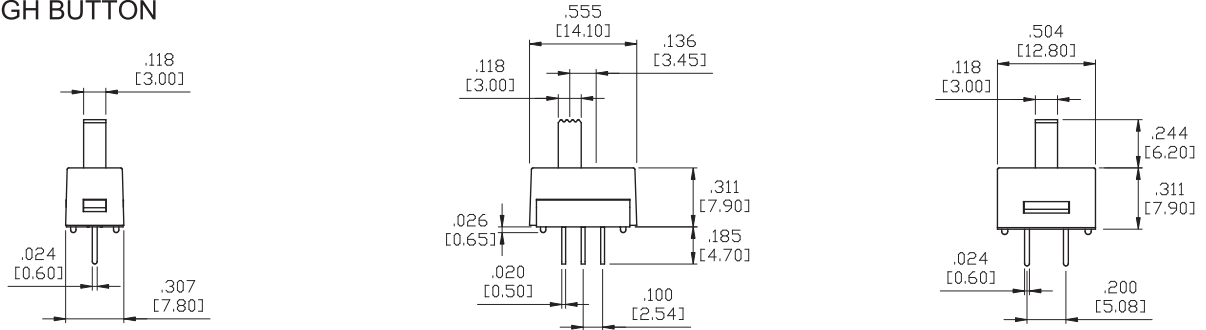

S6 EXTRA HIGH BUTTON

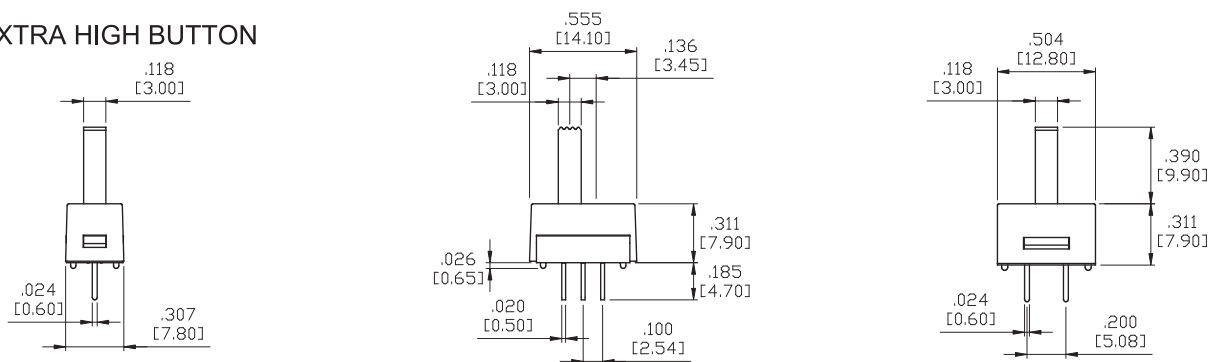

SPACING OPTIONS

M1

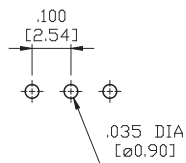

M2

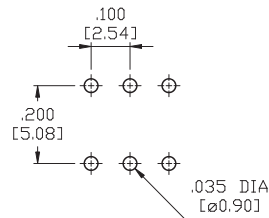

M3

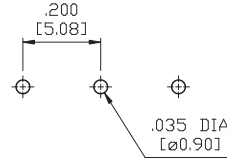

M4

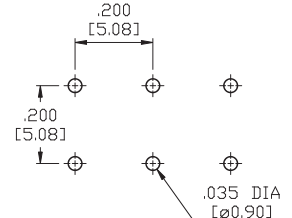

CONTACT MATERIAL OPTIONS

Coding	Contact Material	Terminal Plating	Rating	Agency Approvals
Q	Silver <sup>1</sup>	Silver plated <sup>1</sup>	2Amps @ 250VAC	
R	Gold <sup>2</sup>	Gold plated <sup>3</sup>	0.1Amps @ 30VDC	

1. Movable Contact & Terminals: Copper alloy, silver plated.
2. Movable Contact: Copper alloy with gold plated over nickel plated.
3. Terminals: Copper alloy, with gold plated over nickel plated.